

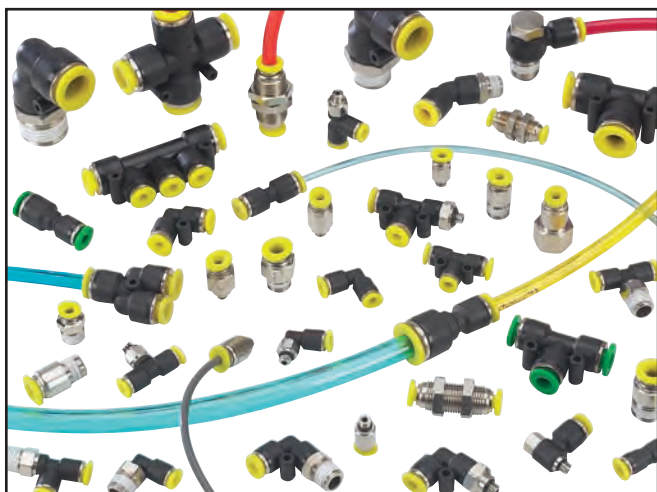

PUSH-QUICK FITTINGS



Clippard Push-Quick Fittings provide a simple method of connecting pneumatic components to each other and system piping. They are designed for use with both flexible hose and stiff tubing made of nylon, urethane, polyethylene or polypropylene.

- Pressure Range:** 0 - 150 psig @ 130°F
- Vacuum:** 0 to 29.5" Hg
- Temperature Range:** 32 to 140°F
- Media:** Air, Non-corrosive water
- Tube Pull Out Force:** >20 lb. @ 75°F (non-pressurized)
- Burst Pressure:** 350 psig @ 75°F
- Materials:** Body - Plastic Resin
Metal Stud - Nickel Plated Brass
Gripper Ring - Stainless Steel
Seals - Buna-N

Push-Quick Fittings generally provide higher flows than barbed fittings. The Push-Quick fitting allows full flow through the hose/tubing I.D. with no smaller orifice required as in barb fittings. The chart shows the comparison between barb and push in fittings for various tubing/hose sizes. Push-Quick Fittings are available in nine sizes for 1/8", 5/32", 6 mm, 1/4" and 3/8" O.D. tubing. The 5/32" fittings may also be used with 4 mm O.D. tubing.

Installation of Tubing into fitting

1. Slowly push a clean and perpendicularly cut tubing into the fitting until it comes to a dead stop.
2. Pull the tubing back gently until the Gripper Ring of the fitting grips onto the tubing and has a good seal.

Removal of Tubing from fitting

1. Push in evenly on the two long oval sides of the Release Button.
2. Pull out the tubing while keeping the Release Button depressed.
3. To reuse the tubing; cut off the lodged portion of the previously used tubing evenly and perpendicularly.

Installation of Pipe Fittings with Pre-Applied sealant

1. Tighten fitting by hand, then turn it 2 or 3 turns with a wrench until it reaches the desired torque listed.
2. If the fitting is used and the sealant coating is not in good condition, apply Teflon® sealant tape to the threads.



* 6 mm size fittings have a green release button

Barb vs Push-Quick Fittings
Flow Comparison @ 100 psig

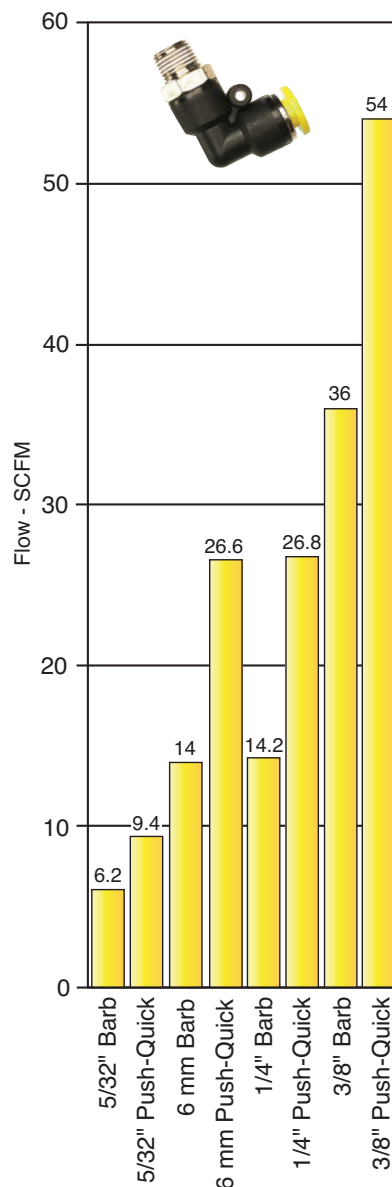

| Thread Size | #10-32 | 1/8" NPT, R1/8 | 1/4" NPT, R1/4 | 3/8" NPT | 1/2" NPT |
|------------------|-----------|----------------|----------------|-------------|-----------|
| Torque lb. - ft. | 1.0 - 1.5 | 5.0 - 6.5 | 8.5 - 10.0 | 16.0 - 17.5 | 20 - 21.5 |

| Tubing Material | Polyurethane | Polyethylene | Polypropylene | Nylon |
|----------------------|---------------------|----------------------|----------------------|------------|
| Specified Size | +/- 0.005" | +/- 0.004" | +/- 0.004" | +/- 0.004" |
| Hardness (Durometer) | Shore A85 or higher | Shore D 44 or higher | Shore D 44 or higher | Shore D 44 |

see pages 322 through 327 for hose and tubing

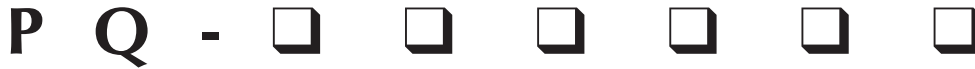

| Fitting Type | | Tubing Size (O.D.) | | Thread Size |
|--------------------------------|----------------------------------|-----------------------------|----------------------------|---------------------|
| BC - Bulkhead Connector | MA - Male Angle Connector | RU - Reduced Union | 04 - 1/8" (0.125") | N - #10-32 |
| BT - Branch Tee | MC - Male Connector | SC - Stem Coupler | 04M - 4 mm (0.157") | 5 - M5 Thd. |
| BU - Bulkhead Union | ME - Male Elbow | SE - Stack Elbow | 05 - 5/32" (0.156") | 6 - M6 Thd. |
| CC - Compact Male Conn. | MM - Male Manifold | SR - Stem Reducer | 06M - 6 mm (0.236") | P - 1/8" NPT |
| CU - Cross Union | MU - Manifold Union | SU - Straight Union | 08 - 1/4" (0.250") | R - R1/8 |
| EE - Extended Elbow | PE - Plug-In Elbow | TU - Tee Union | 08M - 8 mm (0.313") | Q - 1/4" NPT |
| ER - Elbow Reducer | PG - Plug | TR - Tube Reducer | 10 - 5/16" (0.313") | 2 - R1/4 |
| EU - Elbow Union | RB - Reduced Branch | UE - Universal Elbow | 12 - 3/8" (0.375") | W - 3/8" NPT |
| FC - Female Connector | RT - Run Tee | YC - Y Connector | 16 - 1/2" (0.500") | 3 - R3/8 |
| FE - Female Elbow | | YU - Y Union | | Z - 1/2" NPT |

Threaded Fittings



Female Connector
Page 292



Male Compact Connector
Page 292



Male Connector
Page 292



Bulkhead Connector
Page 296



Male Angle Connector
Page 295



Y Connector
Page 294



Female Elbow
Page 294



Male Elbow
Page 293



Extended Elbow
Page 294



Universal Elbow
Page 294



Stack Elbow
Page 295



Run Tee
Page 293



Branch Tee
Page 293



Manifold Mount
Page 295

Non-Threaded Fittings



Straight Union
Page 296



Reduced Union
Page 297



Elbow Union
Page 296



Tee Union
Page 296



Y Union
Page 297



Cross Union
Page 296



Manifold Union
Page 296



Bulkhead Union
Page 296



Reduced Branch
Page 297



Elbow Reducer
Page 297



Tube Reducer
Page 297



Plug-In Elbow
Page 297



Tee Reducer
Page 297



Stem Reducer
Page 298



Stem Coupler
Page 298



PUSH-QUICK FITTINGS

Female Connector

(10/pack)

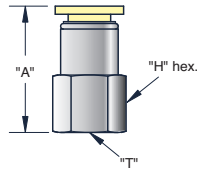

| Tube | Thread "T" | Part No. | "A" | "H" Hex. |
|-------|------------|---------------------------|--------|----------|
| 5/32" | #10-32 | PQ-FC05N | 0.905" | 7/16" |
| | 1/8" NPT | PQ-FC05P | 1.080" | 9/16" |
| 4 mm* | M5 x 0.8 | PQ-FC04M5 | 0.905" | 12 mm |
| | R1/8 | PQ-FC04MR | 1.080" | |
| 6 mm* | R1/8 | PQ-FC06MR | 1.080" | 14 mm |
| | R1/4 | PQ-FC06M2 | 1.100" | 17 mm |
| 1/4" | 1/8" NPT | PQ-FC08P | 1.080" | 9/16" |
| | 1/4" NPT | PQ-FC08Q | 1.220" | 11/16" |
| 5/16" | 1/8" NPT | PQ-FC10P | 1.170" | 11/16" |
| | 1/4" NPT | PQ-FC10Q | 1.250" | 11/16" |
| | 3/8" NPT | PQ-FC10W | 1.260" | 7/8" |
| 8 mm* | R1/8 | PQ-FC08MR | 1.170" | 17 mm |
| | R1/4 | PQ-FC08M2 | 1.170" | 17 mm |
| | R3/8 | PQ-FC08M3 | 1.250" | 19 mm |
| 3/8" | 1/4" NPT | PQ-FC12Q | 1.380" | 7/8" |
| | 3/8" NPT | PQ-FC12W | | |

Male Connector

(10/pack)

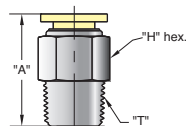

| Tube | Thread "T" | Part No. | "A" | "H" Hex. |
|----------|--------------------------|---------------------------|--------|----------|
| 1/8" | #10-32 | PQ-MC04N | 0.899" | 7/16" |
| | 1/8" NPT | PQ-MC04P | 0.836" | |
| | 1/4" NPT | PQ-MC04Q | 0.920" | |
| 5/32" | #10-32 | PQ-MC05N | 0.899" | 7/16" |
| | 1/8" NPT | PQ-MC05P | 0.836" | 7/16" |
| | 1/4" NPT | PQ-MC05Q | 0.920" | 9/16" |
| 4 mm* | M5 x 0.8 | PQ-MC04M5 | 0.899" | 10 mm |
| | R1/8 | PQ-MC04MR | 0.836" | |
| 6 mm* | M5 x 0.8 | PQ-MC06M5 | 0.948" | 12 mm |
| | R1/8 | PQ-MC06MR | 0.878" | |
| | R1/4 | PQ-MC06M2 | 0.873" | |
| 1/4" | #10-32 | PQ-MC08N | 0.913" | 1/2" |
| | 1/8" NPT | PQ-MC08P | 0.913" | 1/2" |
| | 1/4" NPT | PQ-MC08Q | 0.965" | 9/16" |
| | 3/8" NPT | PQ-MC08W | 0.965" | 11/16" |
| | 1/8" NPT | PQ-MC10P | 1.090" | 9/16" |
| 5/16" | 1/4" NPT | PQ-MC10Q | 1.050" | 9/16" |
| | 3/8" NPT | PQ-MC10W | 1.060" | 11/16" |
| 8 mm* | M5 x 0.8 | PQ-MC08M5 | 1.030" | 14 mm |
| | R1/8 | PQ-MC08MR | 1.030" | |
| | R1/4 | PQ-MC08M2 | 1.060" | |
| | R3/8 | PQ-MC08M3 | 0.950" | |
| 3/8" | 1/8" NPT | PQ-MC12P | 1.280" | 11/16" |
| | 1/4" NPT | PQ-MC12Q | 1.342" | |
| | 3/8" NPT | PQ-MC12W | 1.241" | |
| | 1/2" NPT | PQ-MC12Z | 1.240" | |
| | 1/4" NPT | PQ-MC16Q | 1.342" | |
| 3/8" NPT | PQ-MC16W | 1.241" | | |
| 1/2" | 1/2" NPT | PQ-MC16Z | 1.240" | 7/8" |

Male Compact Connector

(10/pack)

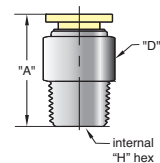

| Tube | Thread "T" | Part No. | "A" | "D" Dia. | "H" Hex. |
|-------|------------|--------------------------|--------|----------|----------|
| 1/8" | #10-32 | PQ-CC04N | 0.880" | 0.410" | 5/64" |
| | 1/8" NPT | PQ-CC04P | 0.860" | | 3/32" |
| 5/32" | #10-32 | PQ-CC05N | 0.890" | 0.400" | 5/64" |
| | 1/8" NPT | PQ-CC05P | 0.840" | | 3/32" |
| 1/4" | #10-32 | PQ-CC08N | 0.910" | 0.470" | 5/64" |
| | 1/8" NPT | PQ-CC08P | 0.910" | | 5/32" |
| | 1/4" NPT | PQ-CC08Q | 0.970" | | 5/32" |
| 3/8" | 1/4" NPT | PQ-CC12Q | 1.340" | 0.670" | 7/32" |
| | 3/8" NPT | PQ-CC12W | 1.240" | | 5/16" |

* Fittings have a green release button.

Note: Fittings with pipe thread NPT, R1/8, R1/4 and R3/8 are supplied with pre-applied sealant.

Run Tee

(5/pack)

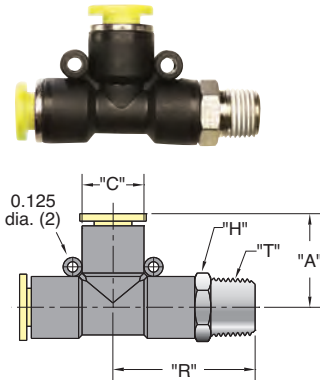

| Tube | Thread "T" | Part No. | "A" | "C" | "H" Hex. | "R" |
|-------|----------------------------------|-------------------------------------|--------|--------|--------------------------|----------------------------|
| 1/8" | 1/8" NPT | PQ-RT04P | 0.722" | 0.410" | 7/16" | 0.980" |
| 5/32" | #10-32 1/8" NPT | PQ-RT05N PQ-RT05P | 0.722" | 0.410" | 7/16" | 0.900" 0.980" |
| 4 mm* | M5 x 0.8 R1/8 | PQ-RT04M5 PQ-RT04MR | 0.722" | 0.410" | 10 mm | 0.900" 0.980" |
| 6 mm* | M5 x 0.8 R1/8 R1/4 | PQ-RT06M5 PQ-RT06MR PQ-RT06M2 | 0.830" | 0.524" | 12 mm 12 mm 14 mm | 1.030" 1.100" 1.140" |
| 1/4" | #10-32 1/8" NPT 1/4" NPT | PQ-RT08N PQ-RT08P PQ-RT08Q | 0.840" | 0.524" | 1/2" 1/2" | 1.030" 1.100" 1.230" |
| 5/16" | 1/8" NPT 1/4" NPT 3/8" NPT | PQ-RT10P PQ-RT10Q PQ-RT10W | 0.880" | 0.580" | 9/16" 9/16" 11/16" | 1.100" 1.230" 1.290" |
| 8 mm* | R1/8 R1/4 R3/8 | PQ-RT08MR PQ-RT08M2 PQ-RT08M3 | 0.880" | 0.580" | 14 mm | 1.290" |
| 3/8" | 1/8" NPT 1/4" NPT 3/8" NPT | PQ-RT12P PQ-RT12Q PQ-RT12W | 1.100" | 0.720" | 11/16" | 1.380" 1.470" 1.500" |

Branch Tee

(5/pack)

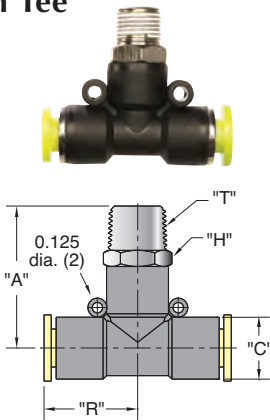

| Tube | Thread "T" | Part No. | "A" | "C" | "H" Hex. | "R" |
|-------|----------------------------------|-------------------------------------|----------------------------|--------|-------------------------|--------|
| 5/32" | #10-32 1/8" NPT | PQ-BT05N PQ-BT05P | 0.900" 0.980" | 0.410" | 7/16" | 0.722" |
| 4 mm* | M5 x 0.8 R1/8 | PQ-BT04M5 PQ-BT04MR | 0.900" 0.980" | 0.410" | 10 mm | 0.722" |
| 6 mm* | M5 x 0.8 R1/8 R1/4 | PQ-BT06M5 PQ-BT06MR PQ-BT06M2 | 1.030" 1.100" 1.140" | 0.524" | 12 mm 12 mm 14 mm | 0.830" |
| 1/4" | #10-32 1/8" NPT 1/4" NPT | PQ-BT08N PQ-BT08P PQ-BT08Q | 1.030" 1.100" 1.230" | 0.524" | 1/2" | 0.840" |
| 5/16" | 1/8" NPT 1/4" NPT | PQ-BT10P PQ-BT10Q | 1.100" 1.230" | 0.580" | 9/16" | 0.880" |
| 8 mm* | R1/8 R1/4 R3/8 | PQ-BT08MR PQ-BT08M2 PQ-BT08M3 | 1.290" | 0.580" | 14 mm | 0.880" |
| 3/8" | 1/8" NPT 1/4" NPT 3/8" NPT | PQ-BT12P PQ-BT12Q PQ-BT12W | 1.290" 1.470" 1.500" | 0.720" | 11/16" | 1.100" |

Male Elbow

(10/pack)

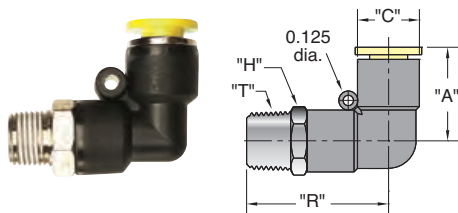

| Tube | Thread "T" | Part No. | "A" | "C" | "H" Hex. | "R" |
|-------|--|--|--------|--------|------------------------------------|--------------------------------------|
| 1/8" | #10-32 1/8" NPT | PQ-ME04N PQ-ME04P | 0.722" | 0.410" | 7/16" | 0.900" 0.980" |
| 5/32" | #10-32 1/8" NPT 1/4" NPT | PQ-ME05N PQ-ME05P PQ-ME05Q | 0.722" | 0.410" | 7/16" | 0.900" 0.980" 1.130" |
| 4 mm* | M5 x 0.8 R1/8 | PQ-ME04M5 PQ-ME04MR | 0.722" | 0.410" | 10 mm | 0.900" 0.980" |
| 6 mm* | M5 x 0.8 R1/8 R1/4 | PQ-ME06M5 PQ-ME06MR PQ-ME06M2 | 0.830" | 0.524" | 12 mm 12 mm 14 mm | 1.030" 1.100" 1.140" |
| 1/4" | #10-32 1/8" NPT 1/4" NPT 3/8" NPT | PQ-ME08N PQ-ME08P PQ-ME08Q PQ-ME08W | 0.840" | 0.524" | 1/2" 1/2" 9/16" 11/16" | 1.030" 1.100" 1.230" 1.290" |
| 5/16" | 1/8" NPT 1/4" NPT 3/8" NPT | PQ-ME10P PQ-ME10Q PQ-ME10W | 0.880" | 0.580" | 9/16" 9/16" 11/16" | 1.100" 1.230" 1.290" |
| 8 mm* | R1/8 R1/4 R3/8 | PQ-ME08MR PQ-ME08M2 PQ-ME08M3 | 0.880" | 0.580" | 14 mm | 1.290" |
| 3/8" | 1/8" NPT 1/4" NPT 3/8" NPT 1/2" NPT | PQ-ME12P PQ-ME12Q PQ-ME12W PQ-ME12Z | 1.100" | 0.720" | 11/16" 11/16" 11/16" 7/8" | 1.350" 1.470" 1.500" 1.600" |
| 1/2" | 1/4" NPT 3/8" NPT 1/2" NPT | PQ-ME16Q PQ-ME16W PQ-ME16Z | 1.160" | 0.850" | 7/8" | 1.550" 1.580" 1.670" |

* Fittings have a green release button.
Note: Fittings with pipe thread NPT, R1/8, R1/4 and R3/8 are supplied with pre-applied sealant.



PUSH-QUICK FITTINGS

Female Elbow

(5/pack)

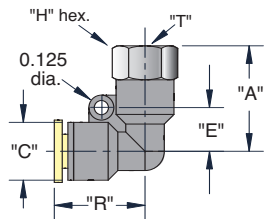

| Tubeing | Thread "T" | Part No. | "A" | "C" | "H" Hex. | "R" |
|---------|------------|--------------------------|--------|--------|----------|--------|
| 1/8" | #10-32 | PQ-FE04N | 0.830" | 0.410" | 7/16" | 0.720" |
| | 1/8" NPT | PQ-FE04P | 0.950" | | | |
| 5/32" | #10-32 | PQ-FE05N | 0.850" | 0.410" | 7/16" | 0.722" |
| | 1/8" NPT | PQ-FE05P | 0.990" | | | |
| | 1/4" NPT | PQ-FE05Q | 0.980" | | | |
| 1/4" | #10-32 | PQ-FE08N | 0.940" | 0.524" | 7/16" | 0.840" |
| | 1/8" NPT | PQ-FE08P | 1.030" | | | |
| | 1/4" NPT | PQ-FE08Q | 1.190" | 0.580" | 9/16" | 0.900" |
| | 1/8" NPT | PQ-FE10P | 1.120" | | | |
| 5/16" | 1/4" NPT | PQ-FE10Q | 1.220" | 0.720" | 11/16" | 1.100" |
| 3/8" | 1/4" NPT | PQ-FE12Q | 1.390" | | | |
| | 3/8" NPT | PQ-FE12W | 1.420" | | 7/8" | |

Extended Elbow

(5/pack)

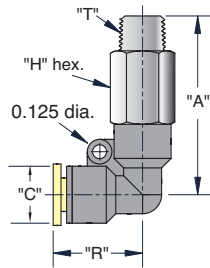

| Tubeing | Thread "T" | Part No. | "A" | "C" | "H" Hex. | "R" | |
|---------|------------|--------------------------|--------|--------|----------|--------|--------|
| 5/32" | #10-32 | PQ-EE05N | 0.722" | 0.410" | 7/16" | 1.360" | |
| | 1/8" NPT | PQ-EE05P | | | | | 1.480" |
| 1/4" | 1/8" NPT | PQ-EE08P | 0.840" | 0.524" | 9/16" | 1.640" | |
| | 1/4" NPT | PQ-EE08Q | | | | | 1.820" |
| | 1/2" NPT | PQ-EE08W | | | | | 1.940" |
| 5/16" | 1/8" NPT | PQ-EE10P | 0.900" | 0.580" | 9/16" | 1.810" | |
| | 1/4" NPT | PQ-EE10Q | | | | | 1.900" |
| | 3/8" NPT | PQ-EE10W | | | | | 2.010" |
| | 1/4" NPT | PQ-EE12Q | | | | | 2.170" |
| 3/8" | 3/8" NPT | PQ-EE12W | 1.100" | 0.720" | 11/16" | 2.170" | |
| | 1/2" NPT | PQ-EE12Z | | | | | 2.560" |
| 1/2" | 3/8" NPT | PQ-EE16W | 1.160" | 0.850" | 11/16" | 2.470" | |
| | 1/2" NPT | PQ-EE16Z | | | | | 2.600" |

Universal Elbow

(5/pack)

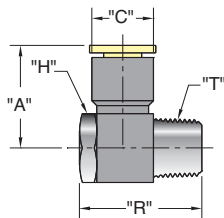

| Tubeing | Thread "T" | Part No. | "A" | "C" | "R" | "H" Hex. | |
|---------|------------|---------------------------|--------|--------|--------|----------|--------|
| 5/32" | #10-32 | PQ-UE05N | 0.820" | 0.410" | 0.790" | 5/16" | |
| | 1/8" NPT | PQ-UE05P | | | | | 1.020" |
| 4 mm* | M5 x 0.8 | PQ-UE04M5 | 0.831" | 0.410" | 0.790" | 8 mm | |
| | R1/8 | PQ-UE04MR | | | | | 0.921" |
| 6 mm* | M5 x 0.8 | PQ-UE06M5 | 0.976" | 0.953" | 0.790" | 12 mm | |
| | R1/8 | PQ-UE06MR | | | | | 0.970" |
| | R1/4 | PQ-UE06M2 | | | | | 1.140" |
| 1/4" | #10-32 | PQ-UE08N | 0.940" | 0.524" | 0.790" | 1/2" | |
| | 1/8" NPT | PQ-UE08P | | | | | 1.020" |
| | 1/4" NPT | PQ-UE08Q | | | | | 1.150" |
| 5/16" | 1/8" NPT | PQ-UE10P | 1.120" | 0.580" | 1.020" | 9/16" | |
| | 1/4" NPT | PQ-UE10Q | | | | | 1.150" |
| | 3/8" NPT | PQ-UE10W | | | | | 1.430" |
| 8 mm* | R1/8 | PQ-UE08MR | 1.120" | 0.580" | 1.000" | 14 mm | |
| | R1/4 | PQ-UE08M2 | | | | | 1.140" |
| | R3/8 | PQ-UE08M3 | | | | | 1.410" |
| | 1/4" NPT | PQ-UE12Q | | | | | 1.180" |
| 3/8" | 1/4" NPT | PQ-UE12Q | 1.320" | 0.720" | 1.430" | 11/16" | |
| | 3/8" NPT | PQ-UE12W | | | | | |

Y Connector

(5/pack)

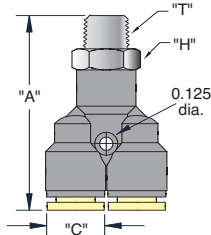

| Tubeing | Thread "T" | Part No. | "A" | "C" | "H" Hex. | |
|---------|------------|--------------------------|--------|--------|----------|--------|
| 1/8" | #10-32 | PQ-YC04N | 1.630" | 0.410" | 7/16" | |
| | 1/8" NPT | PQ-YC04P | | | | 1.660" |
| 5/32" | #10-32 | PQ-YC05N | 1.630" | 0.410" | 7/16" | |
| | 1/8" NPT | PQ-YC05P | | | | 1.660" |
| 1/4" | #10-32 | PQ-YC08N | 1.690" | 0.524" | 1/2" | |
| | 1/8" NPT | PQ-YC08P | | | | 1.770" |
| | 1/4" NPT | PQ-YC08Q | | | | 1.830" |
| 5/16" | 1/8" NPT | PQ-YC10P | 1.830" | 0.580" | 9/16" | |
| | 1/4" NPT | PQ-YC10Q | | | | 1.900" |
| 3/8" | 1/4" NPT | PQ-YC12Q | 2.340" | 0.720" | 11/16" | |
| | 3/8" NPT | PQ-YC12W | | | | 2.400" |
| 1/2" | 3/8" NPT | PQ-YC16W | 2.500" | 0.850" | 7/8" | |
| | 1/2" NPT | PQ-YC16Z | | | | 2.600" |

* Fittings have a green release button.

Note: Fittings with pipe thread NPT, R1/8, R1/4 and R3/8 are supplied with pre-applied sealant.

Male Angle Connector

(10/pack)

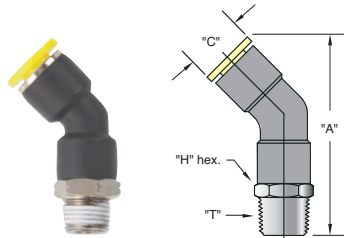

| Tubing | Thread "T" | Part No. | "H" Hex. | "A" | "C" |
|--------|--|--|---------------------------------|--------------------------------------|--------|
| 1/8" | #10-32 1/8" NPT | PQ-MA04N PQ-MA04P | 7/16" | 1.454" 1.474" | 0.410" |
| 5/32" | #10-32 1/8" NPT | PQ-MA05N PQ-MA05P | 7/16" | 1.454" 1.474" | 0.410" |
| 4 mm* | M5 x 0.8 R1/8 | PQ-MA04M5 PQ-MA04MR | 10 mm | 1.454" 1.474" | 0.410" |
| 6 mm* | M5 x 0.8 R1/8 R1/4 | PQ-MA06M5 PQ-MA06MR PQ-MA06M2 | 12 mm 10 mm 14 mm | 1.556" 1.556" 1.616" | 0.520" |
| 1/4" | #10-32 1/8" NPT 1/4" NPT 3/8" NPT | PQ-MA08N PQ-MA08P PQ-MA08Q PQ-MA08W | 1/2" 1/2" 9/16" 11/16" | 1.620" 1.620" 1.682" 1.722" | 0.520" |
| 5/16" | 1/8" NPT 1/4" NPT | PQ-MA10P PQ-MA10Q | 9/16" | 1.800" | 0.580" |
| 3/8" | 1/8" NPT 1/4" NPT 3/8" NPT | PQ-MA12P PQ-MA12Q PQ-MA12W | 11/16" | 1.823" 1.923" 1.943" | 0.720" |
| 1/2" | 1/4" NPT 3/8" NPT 1/2" NPT | PQ-MA16Q PQ-MA16W PQ-MA16Z | 7/8" | 1.965" 2.125" 2.195" | 0.830" |

Stack Elbow

(5/pack)

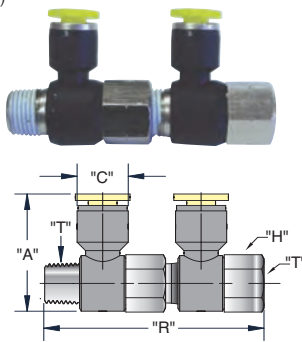

| Tubing | Thread "T" | Part No. | "A" | "C" | "R" | "H" Hex. |
|--------|--------------------------------|--|----------------------------|--------|--------|----------------|
| 5/32" | #10-32 1/8" NPT | PQ-SE05N PQ-SE05P | 0.980" 1.095" | 0.410" | 1.435" | 5/16" 1/2" |
| 1/4" | #10-32 1/8" NPT 1/4" NPT | PQ-SE08N PQ-SE08P PQ-SE08Q | 1.165" 1.200" 1.365" | 0.524" | 2.250" | 1/2" 11/16" |
| 5/16" | 1/4" NPT 3/8" NPT | PQ-SE10Q PQ-SE10W | 1.425" 1.570" | 0.580" | 2.600" | 11/16" |
| 3/8" | 1/4" NPT 3/8" NPT | PQ-SE12Q PQ-SE12W | 1.625" 1.690" | 0.720" | 2.900" | 3/4" |
| 1/2" | 3/8" NPT 1/2" NPT | PQ-SE16W PQ-SE16Z | 1.740" 1.950" | 0.850" | 2.970" | 3/4" 1" |

Manifold Mount

(5/pack)

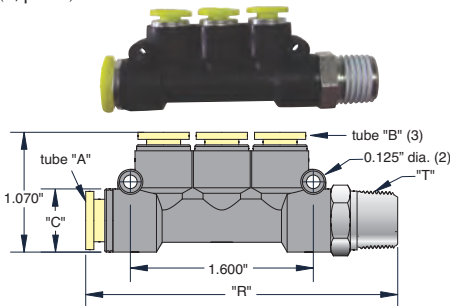

| Tube "A" | Tube "B" | Thread "T" | Part No. | "C" | "R" |
|----------|----------|------------|----------------------------|--------|--------|
| 1/4" | 5/32" | 1/8" NPT | PQ-MM0805P | 0.524" | 2.665" |
| 5/16" | 1/4" | 1/4" NPT | PQ-MM1008Q | 0.580" | 2.820" |

* Fittings have a green release button.

Note: Fittings with pipe thread NPT, R1/8, R1/4 and R3/8 are supplied with pre-applied sealant.



PUSH-QUICK FITTINGS

Bulkhead Connector

(5/pack)

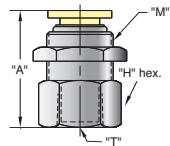

| Tube | Thread "T" | Part No. | "A" | Thread "M" | "H" Hex. |
|-------|------------|---------------------------|--------|------------|----------|
| 1/8" | 1/8" NPT | PQ-BC04P | 1.052" | M12x1 | 9/16" |
| 5/32" | 1/8" NPT | PQ-BC05P | 1.052" | M12x1 | 9/16" |
| 4 mm* | R1/8 | PQ-BC04MR | 1.052" | M12x1 | 14 mm |
| 6 mm* | R1/8 | PQ-BC06MR | 1.080" | M14x1 | 17 mm |
| | R1/4 | PQ-BC06M2 | 1.150" | | |
| 1/4" | 1/8" NPT | PQ-BC08P | 1.084" | M14x1 | 11/16" |
| | 1/4" NPT | PQ-BC08Q | 1.209" | | |
| 5/16" | 1/8" NPT | PQ-BC10P | 1.150" | M16x1 | 11/16" |
| | 1/4" NPT | PQ-BC10Q | 1.195" | | |
| 8 mm* | R1/8 | PQ-BC08MR | 1.125" | M16x1 | 17 mm |
| | R1/4 | PQ-BC08M2 | 1.170" | | |
| 3/8" | 1/4" NPT | PQ-BC12Q | 1.400" | M20x1 | 7/8" |
| | 3/8" NPT | PQ-BC12W | 1.415" | | |
| 1/2" | 1/2" NPT | PQ-BC16Z | 1.525" | M22x1 | 1" |

Bulkhead Union

(5/pack)

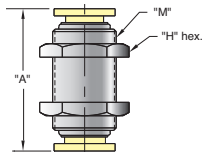

| Tube | Part No. | "A" | Thread "M" | "H" Hex. |
|-------|--------------------------|--------|------------|----------|
| 1/8" | PQ-BU04 | 0.415" | M12 x 1 | 14 mm |
| 5/32" | PQ-BU05 | 1.370" | M12 x 1 | 5/8" |
| 6 mm* | PQ-BU06M | 1.390" | M14 x 1 | 17 mm |
| 1/4" | PQ-BU08 | 1.421" | M14 x 1 | 3/4" |
| 5/16" | PQ-BU10 | 1.610" | M16 x 1 | 3/4" |
| 3/8" | PQ-BU12 | 1.723" | M20 x 1 | 15/16" |
| 1/2" | PQ-BU16 | 1.770" | M22 x 1 | 1" |

Straight Union

(10/pack)

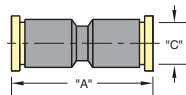

| Tube | Part No. | "A" | "C" |
|-------|--------------------------|--------|--------|
| 1/8" | PQ-SU04 | 1.240" | 0.410" |
| 5/32" | PQ-SU05 | 1.239" | 0.410" |
| 6 mm* | PQ-SU06M | 1.500" | 0.524" |
| 1/4" | PQ-SU08 | 1.500" | 0.524" |
| 5/16" | PQ-SU10 | 1.540" | 0.580" |
| 3/8" | PQ-SU12 | 1.851" | 0.720" |
| 1/2" | PQ-SU16 | 1.810" | 0.850" |

Elbow Union

(10/pack)

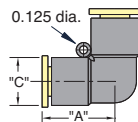

| Tube | Part No. | "A" | "C" |
|-------|--------------------------|--------|--------|
| 1/8" | PQ-EU04 | 0.710" | 0.410" |
| 5/32" | PQ-EU05 | 0.722" | 0.410" |
| 6 mm* | PQ-EU06M | 0.830" | 0.524" |
| 1/4" | PQ-EU08 | 0.840" | 0.524" |
| 5/16" | PQ-EU10 | 0.880" | 0.580" |
| 3/8" | PQ-EU12 | 1.100" | 0.720" |
| 1/2" | PQ-EU16 | 1.130" | 0.850" |

Tee Union

(10/pack)

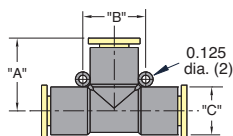

| Tube | Part No. | "A" | "B" | "C" |
|-------|--------------------------|--------|--------|--------|
| 1/8" | PQ-TU04 | 0.710" | 0.656" | 0.410" |
| 5/32" | PQ-TU05 | 0.722" | 0.656" | 0.410" |
| 6 mm* | PQ-TU06M | 0.830" | 0.740" | 0.524" |
| 1/4" | PQ-TU08 | 0.840" | 0.740" | 0.524" |
| 5/16" | PQ-TU10 | 0.880" | 0.800" | 0.580" |
| 3/8" | PQ-TU12 | 1.100" | 0.944" | 0.720" |
| 1/2" | PQ-TU16 | 1.130" | 1.120" | 0.850" |

Cross Union

(5/pack)

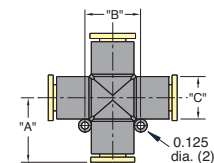

| Tube | Part No. | "A" | "B" | "C" |
|-------|--------------------------|--------|--------|--------|
| 1/8" | PQ-CU04 | 0.710" | 0.560" | 0.410" |
| 5/32" | PQ-CU05 | 0.722" | 0.656" | 0.410" |
| 6 mm* | PQ-CU06M | 0.830" | 0.740" | 0.524" |
| 1/4" | PQ-CU08 | 0.840" | 0.740" | 0.524" |
| 5/16" | PQ-CU10 | 0.880" | 0.800" | 0.580" |
| 3/8" | PQ-CU12 | 1.100" | 0.944" | 0.720" |

Manifold Union

(5/pack)

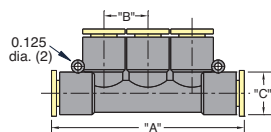

| Tube | Part No. | "A" | "B" | "C" |
|-------|----------------------------|--------|--------|--------|
| 5/32" | PQ-MU0504 | 2.312" | 0.500" | 0.560" |
| 6 mm* | PQ-MU06M05 | 2.435" | 0.531" | 0.524" |
| 1/4" | PQ-MU0805 | 2.435" | 0.531" | 0.524" |
| 5/16" | PQ-MU1008 | 2.435" | 0.580" | 0.580" |
| 3/8" | PQ-MU1208 | 2.312" | 0.562" | 0.725" |

* Fittings have a green release button

Note:
Fittings with pipe thread NPT, R1/8, R1/4 and R3/8 are supplied with pre-applied sealant.

Reduced Union

(10/pack)

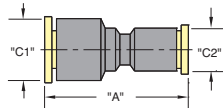

| Tubing | Part No. | "A" | "C1" | "C2" |
|-------------|----------------------------|--------|--------|--------|
| 5/32"-1/8" | PQ-RU0504 | 1.230" | 0.410" | 0.410" |
| 6 mm*-5/32" | PQ-RU06M05 | 1.367" | 0.524" | 0.410" |
| 1/4"-1/8" | PQ-RU0804 | 1.367" | 0.524" | 0.410" |
| 5/16"-1/4" | PQ-RU1008 | 1.550" | 0.580" | 0.524" |
| 3/8"-1/4" | PQ-RU1208 | 1.666" | 0.720" | 0.524" |
| 1/2"-3/8" | PQ-RU1612 | 1.810" | 0.850" | 0.720" |

Y Union

(5/pack)

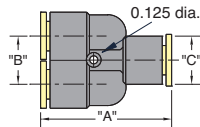

| Tubing | Part No. | "A" | "B" | "C" |
|--------|--------------------------|--------|--------|--------|
| 1/8" | PQ-YU04 | 1.340" | 0.415" | 0.410" |
| 5/32" | PQ-YU05 | 1.318" | 0.517" | 0.410" |
| 6 mm* | PQ-YU06M | 1.495" | 0.531" | 0.524" |
| 1/4" | PQ-YU08 | 1.495" | 0.531" | 0.524" |
| 5/16" | PQ-YU10 | 1.495" | 0.590" | 0.580" |
| 3/8" | PQ-YU12 | 2.017" | 0.720" | 0.720" |
| 1/2" | PQ-YU16 | 2.070" | 0.840" | 0.840" |

Reduced Branch

(5/pack)

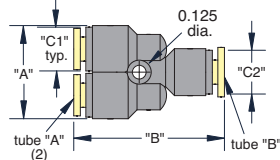

| Tube "A" | Tube "B" | Part No. | "A" | "B" | "C1" | "C2" |
|----------|----------|---------------------------|--------|--------|--------|--------|
| 1/8" | 5/32" | PQ-RB0504 | 0.830" | 1.340" | 0.420" | 0.410" |
| 5/32" | 1/4" | PQ-RB0805 | 0.830" | 1.390" | 0.410" | 0.524" |
| 1/4" | 5/16" | PQ-RB1008 | 1.025" | 1.670" | 0.524" | 0.580" |
| 1/4" | 3/8" | PQ-RB1208 | 1.025" | 1.780" | 0.524" | 0.720" |
| 3/8" | 1/2" | PQ-RB1612 | 1.420" | 2.050" | 0.720" | 0.850" |

Tee Reducer

(5/pack)

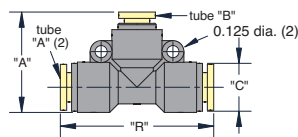

| Tube "A" | Tube "B" | Part No. | "A" | "C" | "R" |
|----------|----------|---------------------------|--------|--------|--------|
| 5/32" | 1/8" | PQ-TR0504 | 0.910" | 0.410" | 1.385" |
| 1/4" | 5/32" | PQ-TR0805 | 1.050" | 0.524" | 1.570" |
| 5/16" | 1/4" | PQ-TR1008 | 1.170" | 0.580" | 1.835" |
| 3/8" | 1/4" | PQ-TR1208 | 1.380" | 0.720" | 2.160" |
| 1/2" | 3/8" | PQ-TR1612 | 1.600" | 0.850" | 2.240" |

Elbow Reducer

(5/pack)

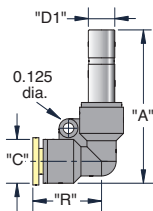

| Tubing | Part No. | "A" | "C" | "D1" | "R" |
|--------|---------------------------|--------|--------|-------|--------|
| 1/8" | PQ-ER0405 | 1.480" | 0.420" | 5/32" | 0.710" |
| 5/32" | PQ-ER0508 | 1.640" | 0.410" | 1/4" | 0.722" |
| 1/4" | PQ-ER0810 | 1.765" | 0.524" | 5/16" | 0.840" |
| 5/16" | PQ-ER1012 | 2.020" | 0.580" | 3/8" | 0.880" |
| 3/8" | PQ-ER1216 | 2.260" | 0.720" | 1/2" | 1.100" |

Plug-In Elbow

(5/pack)

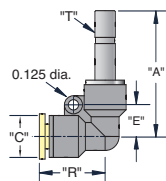

| Tubing | Part No. | "A" | "C" | "E" | "R" |
|--------|-------------------------|--------|--------|--------|--------|
| 1/8" | PQ-PE04 | 1.290" | 0.410" | 0.328" | 0.722" |
| 5/32" | PQ-PE05 | 1.290" | 0.410" | 0.328" | 0.722" |
| 1/4" | PQ-PE08 | 1.550" | 0.524" | 0.370" | 0.840" |
| 5/16" | PQ-PE10 | 1.600" | 0.580" | 0.430" | 0.900" |
| 3/8" | PQ-PE12 | 1.850" | 0.720" | 0.472" | 1.100" |
| 1/2" | PQ-PE16 | 1.940" | 0.850" | 0.570" | 1.160" |

Tube Reducer (Stem)

(10/pack)

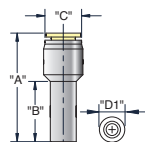

| Tubing | Part No. | "A" | "B" | "C" | "D1" Dia. |
|--------|----------------------------|--------|--------|--------|-----------|
| 1/8" | PQ-TRS0405 | 1.320" | 0.690" | 0.410" | 5/32" |
| 5/32" | PQ-TRS0508 | 1.400" | 0.810" | 0.524" | 1/4" |
| 1/4" | PQ-TRS0810 | 1.480" | 0.850" | 0.580" | 5/16" |
| 1/4" | PQ-TRS0812 | 1.610" | 0.990" | 0.720" | 3/8" |
| 3/8" | PQ-TRS1216 | 1.730" | 0.990" | 0.850" | 1/2" |

* Fittings have a green release button.

Note: Fittings with pipe thread NPT, R1/8, R1/4 and R3/8 are supplied with pre-applied sealant.



PUSH-QUICK FITTINGS

Stem Reducer

(10/pack)

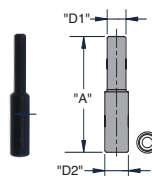

| Tubing | Part No. | "A" | "D1" | "D2" |
|--------|---------------------------|--------|-------|-------|
| 1/8" | PQ-SR0405 | 1.417" | 1/8" | 5/32" |
| 5/32" | PQ-SR0508 | 1.417" | 5/32" | 1/4" |
| 1/4" | PQ-SR0810 | 1.535" | 1/4" | 5/16" |
| 5/16" | PQ-SR1012 | 1.811" | 5/16" | 3/8" |
| 3/8" | PQ-SR1216 | 2.126" | 3/8" | 1/2" |

Stem Coupler

(10/pack)

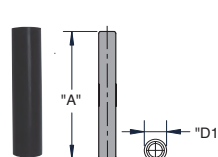

| Tubing | Part No. | "A" | "D1" Dia. |
|--------|-------------------------|--------|-----------|
| 1/8" | PQ-SC04 | 1.378" | 1/8" |
| 5/32" | PQ-SC05 | 1.378" | 5/32" |
| 1/4" | PQ-SC08 | 1.457" | 1/4" |

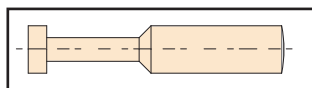

Push-Quick Plugs

Clippard offers a variety of Push-Quick Plugs in sizes to fit 1/8" through 3/8" O.D.,

tubing. These plastic plugs may be used to plug the port of a Push-Quick Fitting for later use. Used as a temporary

plug, they may later be removed and tubing inserted to connect to an additional line of a circuit.

| Part No. | Description | Part No. | Description |
|--------------------------|-----------------|-------------------------|-----------------|
| PQ-PG04 | 1/8" O.D. Tube | PQ-PG08 | 1/4" O.D. Tube |
| PQ-PG05 | 5/32" O.D. Tube | PQ-PG10 | 5/16" O.D. Tube |
| PQ-PG06M | 6 mm O.D. Tube | PQ-PG12 | 3/8" O.D. Tube |

Push-Quick Fitting Adapters

Clippard offers a variety of accessories that are designed for use with Push-Quick Fittings. These include special #10-32 threaded adapters in both male (p/n 11674) and female (p/n 11675) thread configurations and adapters that can be used to plug a Push-Quick fitting.

The threaded adapters insert into Push-Quick Fittings and provide either a male or female thread that can be used to mount any Clippard product with a #10-32 threaded inlet. This allows the direct attachment of the product to a Push-Quick Fitting without hoses or additional fittings.

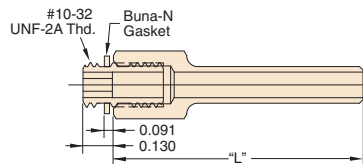

| Part No. | "L" | Tube Size |
|--------------------------|--------|-----------|
| 11674-05 | 1.063" | 5/32" OD |
| 11674-08 | 1.031" | 1/4" OD |
| 11674-12 | 1.218" | 3/8" OD |

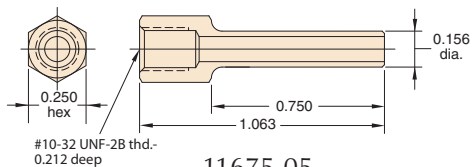

[11675-05](#)
5/32" O.D. Tube

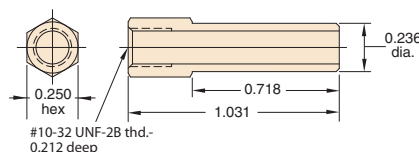

[11675-08](#)
1/4" O.D. Tube

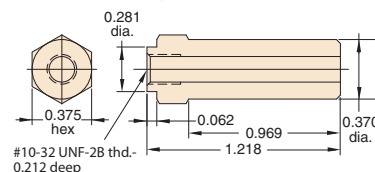

[11675-12](#)
3/8" O.D. Tube

Figure 1 shows an [MAV-3](#) 3-Way Valve connected to a [PQ-RT05P](#) Run Tee using a [11674-05](#) Adapter. In this example, the Run Tee is connected to a 1/8" NPT supply pipe.

Figure 2 shows an [IND-1M-WH](#) Pressure Indicator connected to a [PQ-TU08](#) Tee Union using a [11675-08](#) Adapter. If one of the branches of a Push-Quick Fitting is to be used as a temporary pressure gauge port, the PQ-PGXX series of Plugs can be used when the gauge is not in place. Plugs may also be used if Push-Quick Fitting branches are intended for future additions to the circuit, but have no current need.

Figure 3 shows a [PQ-CU](#) Cross Union with one branch plugged with a [PQ-PG08](#) Plug.

[MAV-3](#)



Figure 1

[11674](#)

Run Tee



[IND-1M-WH](#)



Figure 2

[11675](#)

Tee Union



[PQ-PGXX](#)



Figure 3

Cross Union

